

# CONFERENCE ROOM SOUTH 4F

Venue	Dimensions		Area		Capacity		
	W x L x H (m)	W x L x H (ft)	m <sup>2</sup>	ft <sup>2</sup>	CL	TH	BQ
400	5.6x13.8x3.4	18.4x45.3x11.2	78	834	(Fixed Type) BD 20		
401	16x34x7	52.5x111.5x23	489	5,264	(Fixed Type) TH 441		
402	16.9x16.5x3.4	55.4x54.1x11.2	324	3,488	168	312	160
403	8x16x3.2	26.2x52.5x10.5	144	1,550	72	144	60

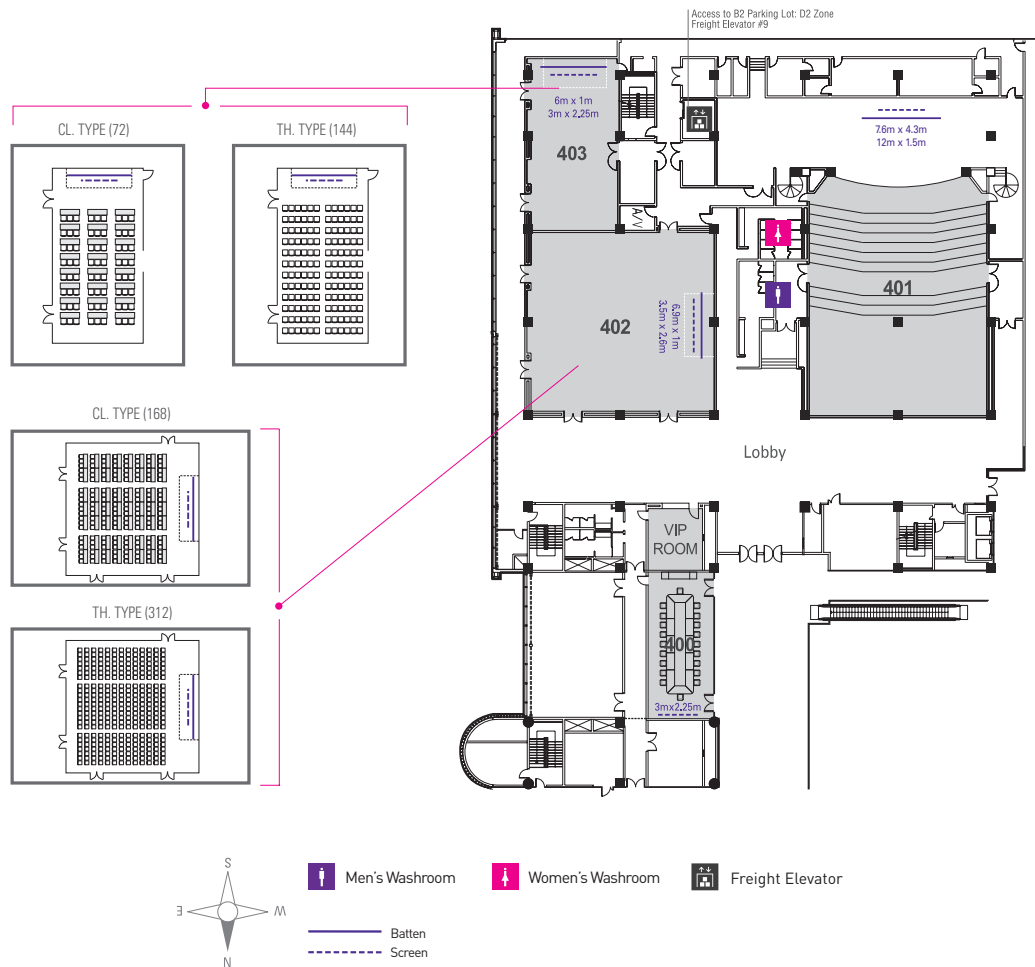

## Details

	401	400, 402~403
<b>Location</b>	- 4th floor	- 4th floor
<b>Floor Space</b>	- 489m <sup>2</sup> (1)	- 78m <sup>2</sup> (1), 144m <sup>2</sup> (1), 324m <sup>2</sup> (1)
<b>Use</b>	- Int'l conferences, symposia, seminars, award ceremonies, musicals, showcases, etc.	- 400 : VIP lounge, board meeting, etc.(fixed type) - 402~403 : meetings, educational sessions, banquets, etc.
<b>Capacity</b>	- 441 seats (theater-style conference room)	- 22(400), 140~300 people(402~403)
<b>Main Facilities</b>	- stage lighting and A/V system - translation booths - stage : 9.4m (W) x 13m (L) x 6m (H) - auto screen : 7.6m x 4.3m	- A/V system - stage : 3m x 11m x 0.2m(402), 2.5m x 6m x 0.2m(403) - auto screen : 3.3 x 1.85m(400), 3.6 x 2.7m(402), 3m x 2m(403)